

Scaffolding for the maintenance of the Basilica of the Nativity in Bethlehem

Designed by CMW Engineering of Florence (Italy) with the sw PON CAD

CMW Engineering of M.Calvelli has provided the scaffolding for the renovation of the Basilica of the Nativity in Bethlehem, the contract of which has been awarded to "PIACENTI" in Prato.

The scaffolding will be used to sealing the entire roof of the Basilica.

Particular attention has been paid by CMW Engineering to ensure safe access to the visitors.

During the course of 2014 the scaffolding will be assemble and then disassemble 5 times using different configurations.

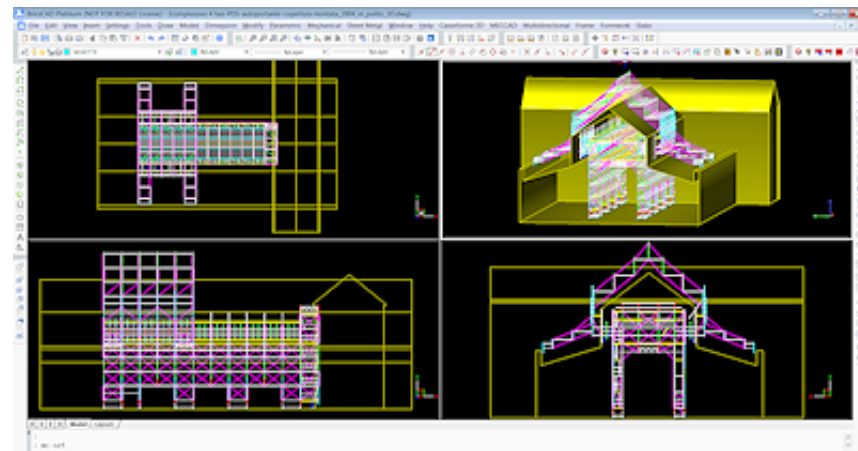

CMW Engineering of Florence uses the software PON CAD for the design



*to design
Scaffolding &
Formworks*

