

## MEC CAD Partner of successful projects

Hanging scaffold at Doha World Trade Center!

Marcegaglia is a leading industrial group worldwide in the steel processing sector. Buildtech division operates on the Metallic Equipments production activity, supplying complete turnkey solutions.

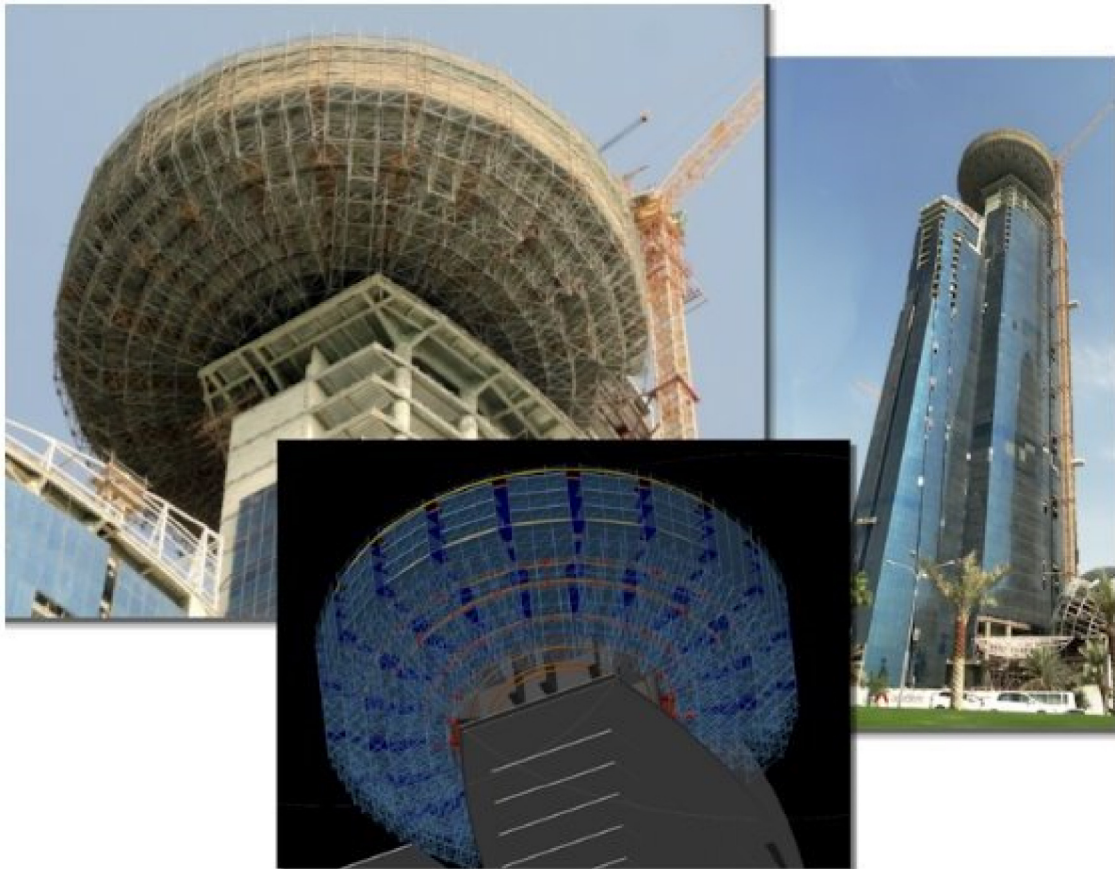

**Subject:** World Trade Center

**Location:** Doha - Qatar

**Objective:** to build a round structure on the top of a skyscraper

**Type of scaffolding:** [SM8 \(eight-connections multidirectional system\)](#)

**Details:** radius: 25 meters

**Difficulty:** the scaffolding was suspended from a [200m high building](#)

**Notes:** it was fundamental to design and simulate the scaffolding structure before assembling it

---

For this scaffolding project Marcegaglia used [PON CAD](#) scaffolding software.

---