



*to design
Scaffolding &
Formworks*

Partner of successful projects

Scaffold designed with PON CAD software

PILOSIO sets up the Scaffolding for the Restoration of an Earthquake affected Church

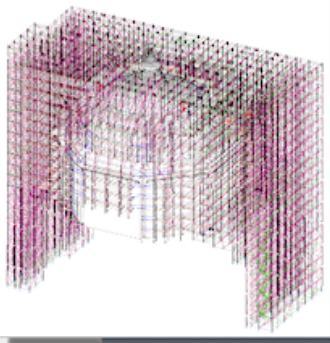

Subject: Basilica of San Bernardino

Location: L'Aquila - Italy

Objective: building restoration

Type of scaffolding: MP multidirectional scaffolding

Details: height: 44m; plan dimensions: 50 x28m; scaffolding volume: 35,000m³

Difficulty: the scaffolding cannot lean on the roofing or other parts of the church, recently affected by a strong earthquake and then statically unsafe. Then, [the scaffold passes over the building without leaning on it.](#)

PILOSIO is a leading European manufacturer of building equipment. Thanks to a 50-years long experience and a highly qualified technical office, it provides an all-round service for the construction industry.



To design this project PILOSIO used PON CAD software

Stay tuned, join MEC CAD!



LinkedIn



Twitter



Facebook

Copyright © 2015 MEC CAD, All rights reserved.

[Unsubscribe from this list](#)