

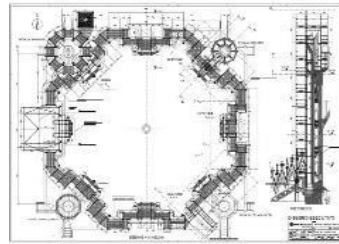

**MARCEGALGIA BUILDTECH designs
the Scaffold for the renovation of Milan Cathedral
using PON CAD**

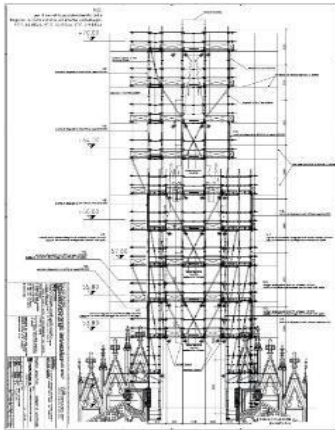



Project name: Milan Cathedral Renovation

The Milan Cathedral is the largest Gothic church in Italy, the fourth in the world by surface and the sixth by volume.

MARCEGAGLIA BUILDTECH has always provided the scaffolding system for the restructuring of all its parts, for example, the roof Cupola with its imposing spires, using PON CAD for the design of the project and the structural calculations.



[Marcegaglia Buildtech](#) is a leading Italian company that produces and supplies steel scaffolding system solutions for residential and industrial construction sites.

PON CAD

Use PON CAD + STRUCT
for the Designing and Verification of your Scaffolds!

[Request more about PON CAD](#)